

# Relay Replacement

---

Relay Replacement guide

 Difficulty Easy

 Duration 5 minute(s)

## Contents

---

Step 1 - Remove Relay from Relay Base

Step 2 - Fitting replacement relay

Comments

# Step 1 - Remove Relay from Relay Base

There Are 2 examples shown for this process.

There is a clip to be unlatched on each relay shown, once unclipped this releases the relay which can then be pulled out.

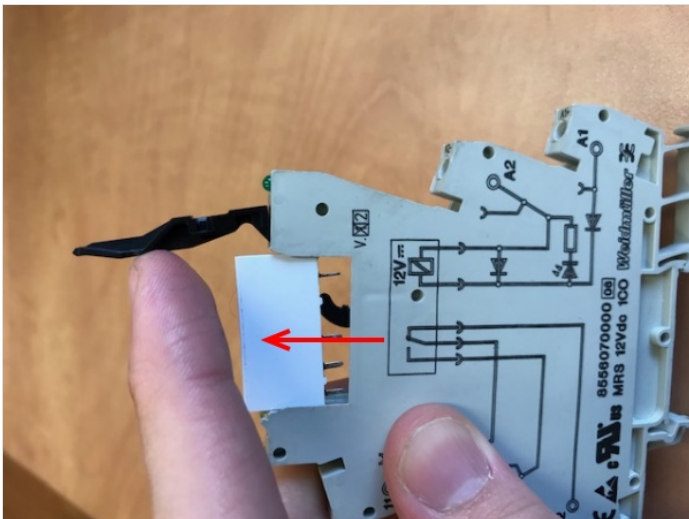
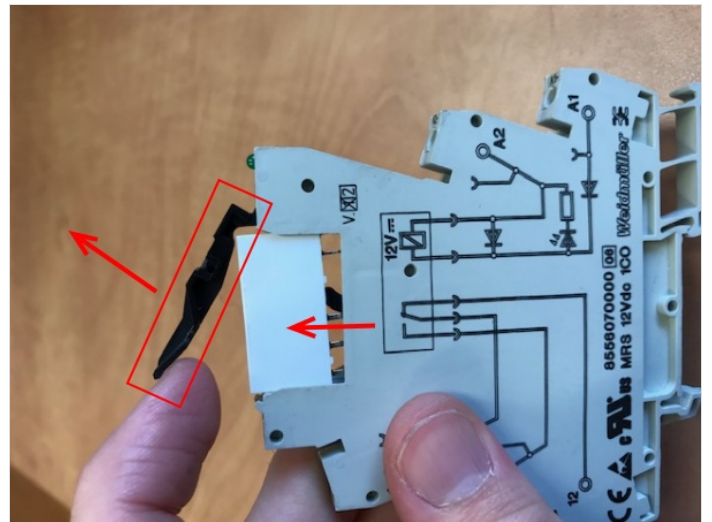
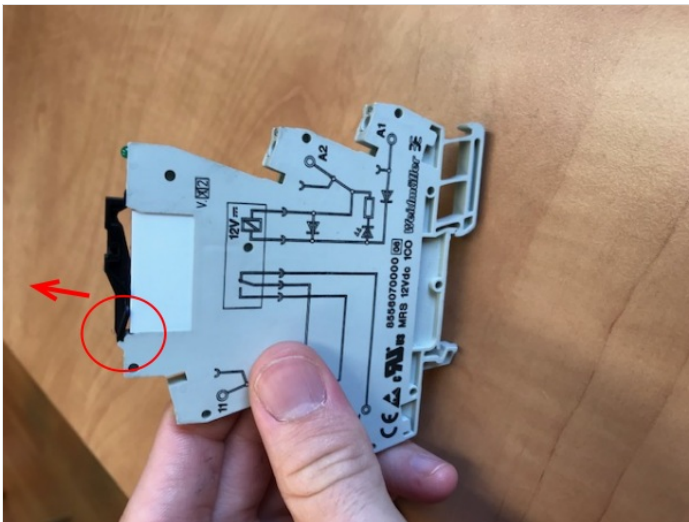
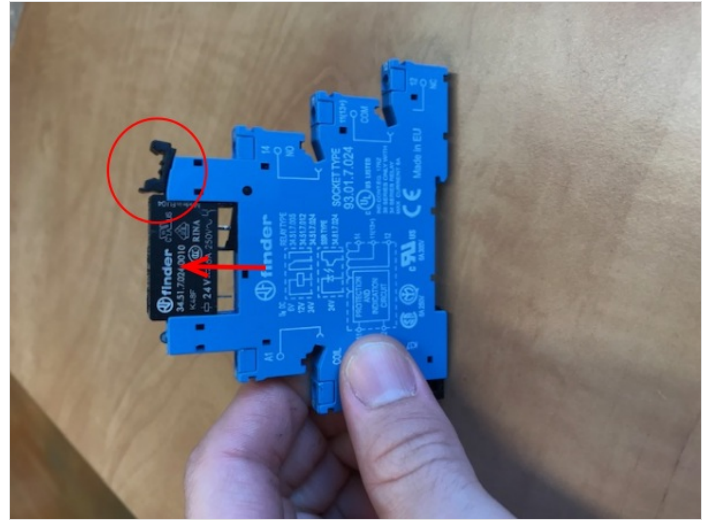
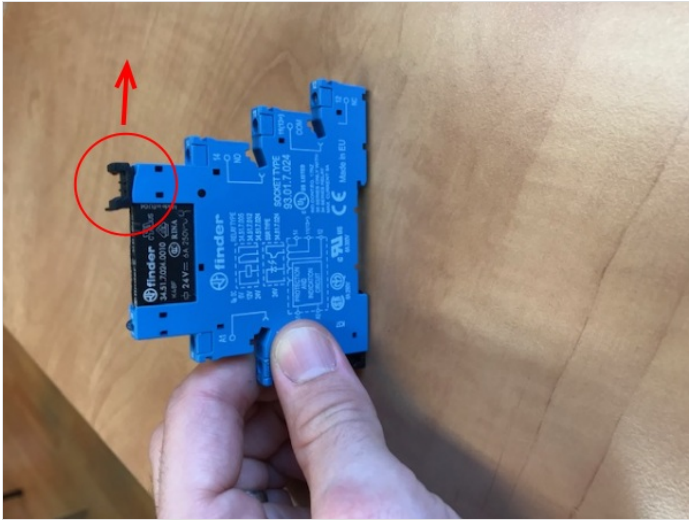

## Step 2 - Fitting replacement relay

 Please ensure pins line up correctly before pushing the relay in

The relay slots in to grooves either side and then pushes down into position. Use clip to then secure the relay in place.

