

# R0015265 Mount Infeed arm covers and End guards

Instructions to fit safety covers to arms

 Difficulty **Medium**

 Duration **2 hour(s)**

## Contents

Introduction

Step 1 - Unless otherwise stated

Step 2 - Check for Ecr work

Step 3 - Fit Arm Guards

Step 4 - Fit End covers

Step 5 - Fit Bungs

Comments

## Introduction

### Tools required

Standard hex key set

### Parts Required

A0000307 Domed Blanking Plug 32mm

D0015457 Infeed Arm End Cover

D0015518B Infeed Arm Guard

## Step 1 - Unless otherwise stated

Use loctite 243 on all fasteners

Use Loctite 572 on all threaded pneumatic connections

Pen mark all bolts to show finalised



## Step 2 - Check for Ecr work

6 off mounting holes have been requested to increase to 5mm on 17/08/23

Check 6 off holes on each arm are 5mm. If not rework to increase hole diameter to 5mm and log rework time

This is to aid fitment of covers onto arms

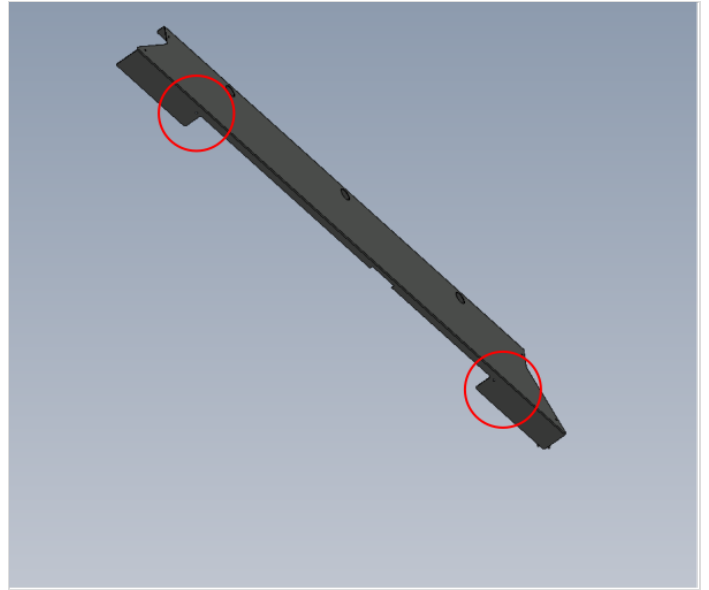
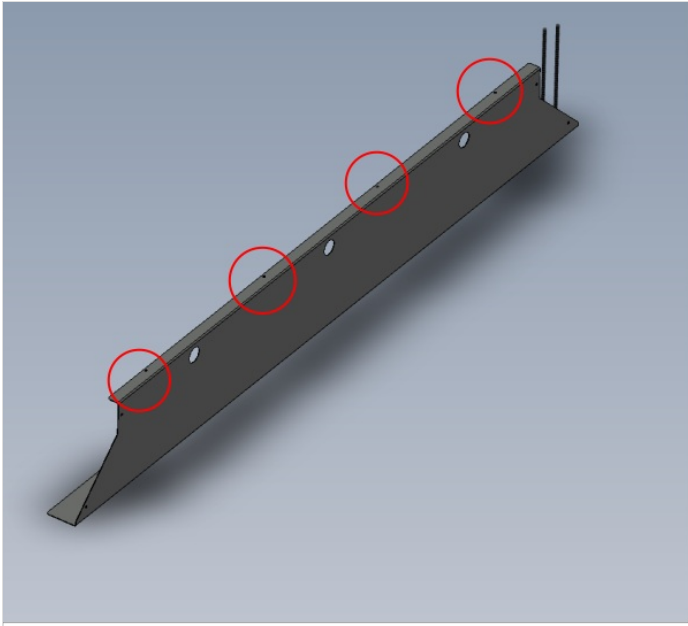

---

## Step 3 - Fit Arm Guards

1 Fit 9 off D0015518B Infeed Arm Guard

Use M4 x 12 socket caps and M4 A form washers to secure

2 When fitting last arm cover, rear end fence will require removing to fit cover.  
Once guard is fitted, add adhesive to end fence fixings and finalise bolts

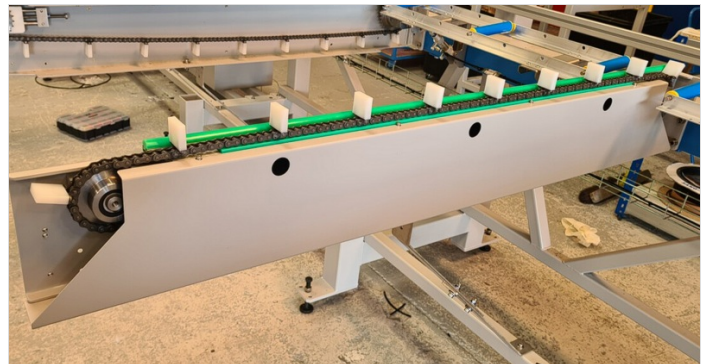
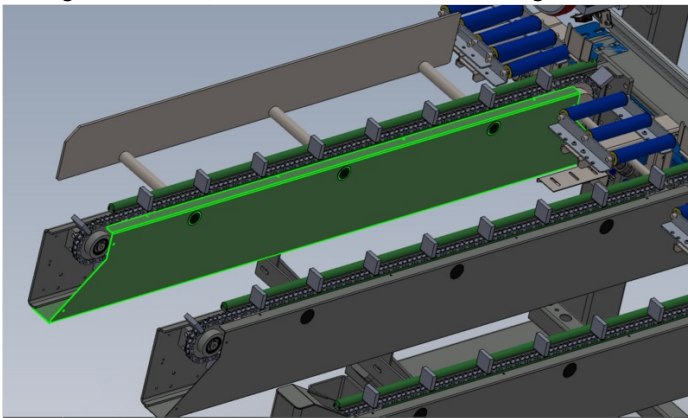

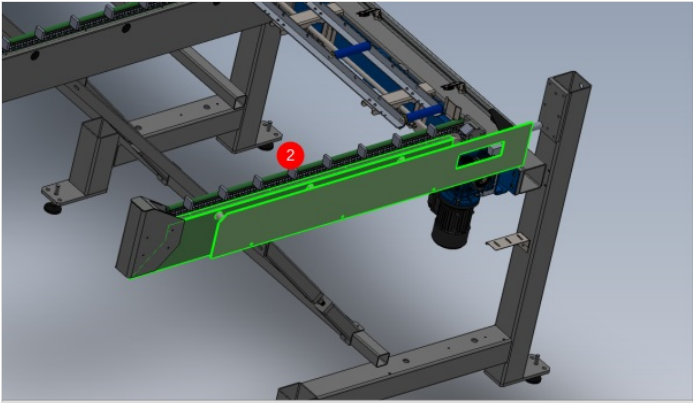

## Step 4 - Fit End covers

Fit 9 off D0015457 Infeed Arm End Cover

Use M6 x 12 socket caps and M6 A form washers

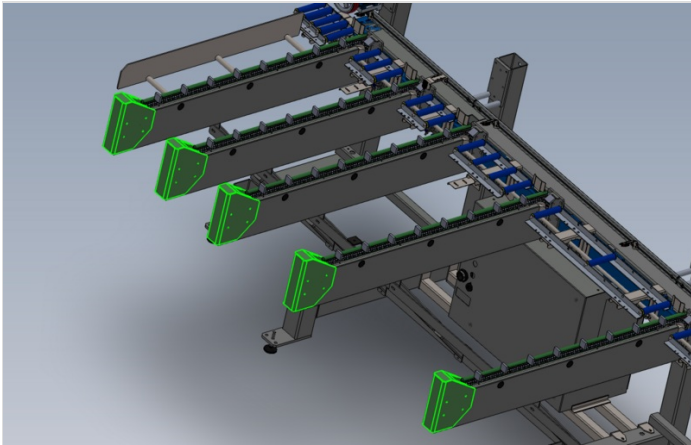

---

## Step 5 - Fit Bungs

Fit 24 off A0000307 Domed Blanking Plug 32mm as shown into arm guards.

