

R0015041 Bench Assemble Top Hood Assembly

Bench assembly details for Saw top Hood

 Difficulty **Medium**

 Duration **6 hour(s)**

Contents

Introduction

Step 1 - Unless otherwise stated

Step 2 - Attach hinges to top hood

Step 3 - Fit top door to hood

Step 4 - In the following step

Step 5 - Fit door switch

Step 6 - Fit acoustic sound proofing

Step 7 - Fit Rear emergency stop

Step 8 - Fit light

Step 9 - Fit Cable retentions

Step 10 - Mount camera

Step 11 - Fit beacon to top hood

Step 12 - Fit console mount bracket

Step 13 - Fit connection box

Step 14 - Fit Top door screen

Step 15 - Attach gas strut

Step 16 - Loom cables

Comments

Introduction

Tools Required

Standard hex key set

Standard spanner set

Standard Hss drill set

Standard tap set

Acoustic foam cutting board and straight edge

Utility Blade

Parts Required

Pre wired light, beacon and network cable from electrical department

C0001152 Camera: HikVision DS-2CD2343G0-I-2.8mm x 1

C0001239 Micro SD Card 32Gb Class 10 x 1

D0000770 Door Hinge (M0016) x 2

D0001877 Saw Top Door Mk4 x 1

D0004641 Hinge Pin Block (D7445) x 1

D0004642 Flap Counterbalance Bar x 1
D0004645 Safety Flap Hinge Pin x 1
D0004679 Flap Stiffening Bar x 1
D0004705 Flap Hinge Bar x 1
D0004747B top door screen x 1
D0004807 Flap x 1
D0007445 Hinge Pin Block OH (D4641) x 1
D0016251 Saw Hood Switch Mount Plate (Bernstein) x 1
E0000275 Button: Base Fixing 1 N/C x 1
E0001072 Emergency Stop Module Bevelled 1NO 1NC x 1
E0001569 Guard Lock Switch: Bernstein Radius Actuator (Key) x 1
H0004643 4mm Axxis Clear 145mm x 690mm x 1
M0000002 12mm Grey Acoustic Foam with Black PVC Facing x 1 (consumable stock)
M0000036 Sign - Ear Protection x 1
M0000048 Gas Spring 15mm x 100mm x 1
M0000539 Handle Black Nylon 200mm M8 Fixings x 1

Step 1 - Unless otherwise stated

All bolts to have Loctite 243 adhesive applied unless otherwise stated

All Threaded Pneumatic connections to have Loctite 570 applied

All bolts to be pen marked once adhesive applied and correct tension added



Step 2 - Attach hinges to top hood

1 Tap 6 off M4 holes on saw hood for hinges

2 Fix 2 off hinges to top hood using 6 off M4 x 12 button

3 Mark hinge positions onto top door , set door even to aperture

4 Drill top door to allow fitment of hinges

5 Remove hinges from top hood and fit to top door using 4 off M4 x 12 button sockets, M4 A form washers, M4 shakeproof washers and standard M4 nuts

6 Attach handle to top door using M8 x 16 socket caps and M8 A form washers

7 Add M0000031 panel edging to top door

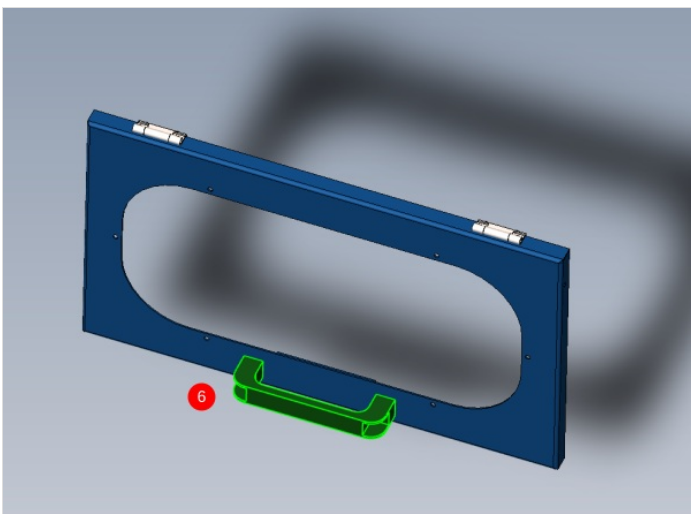
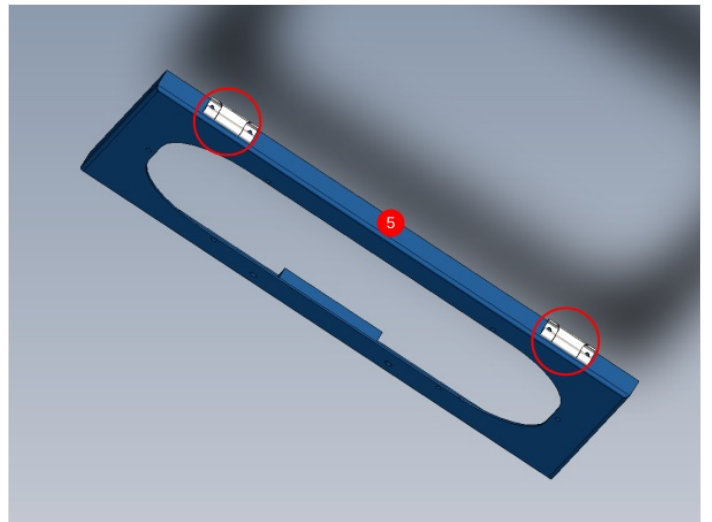
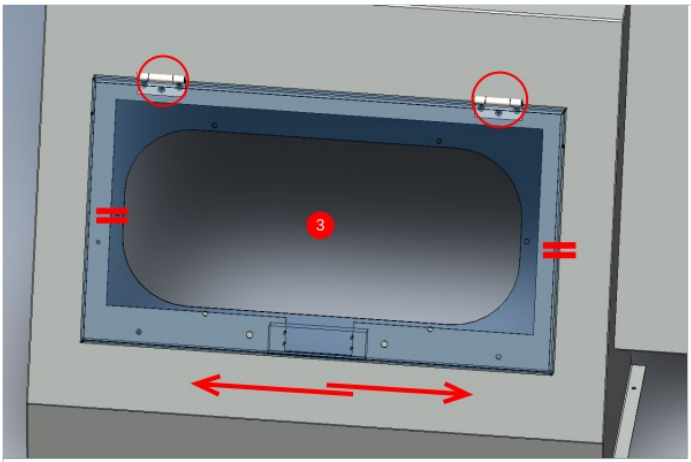
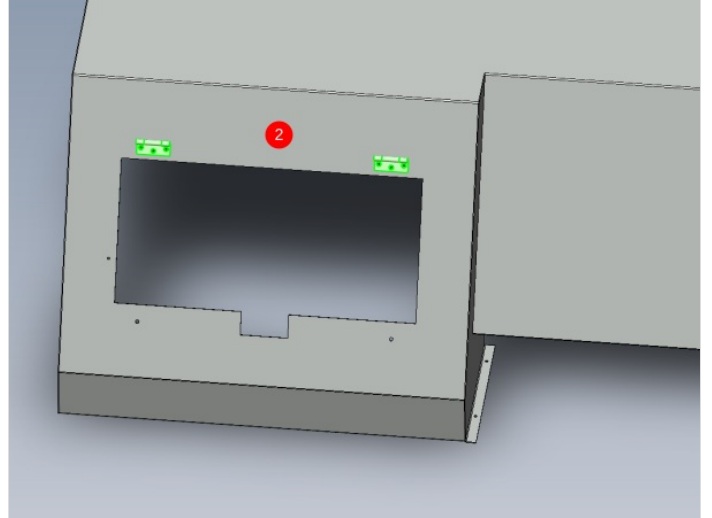
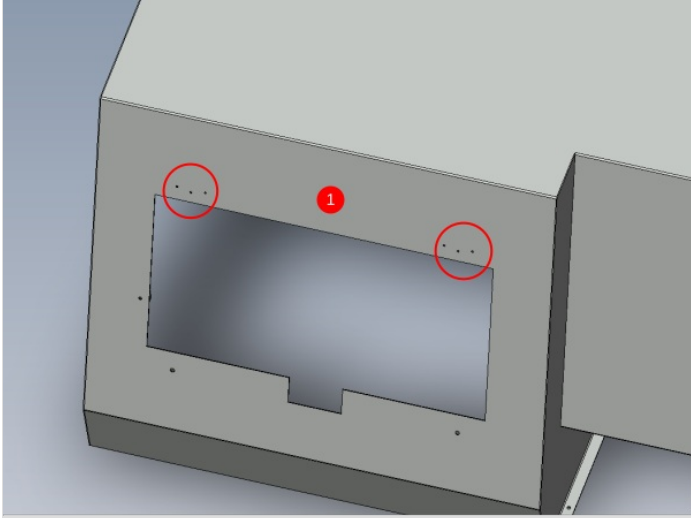

Step 3 - Fit top door to hood

Fit top door to hood using 4 off M4 x 12 button sockets

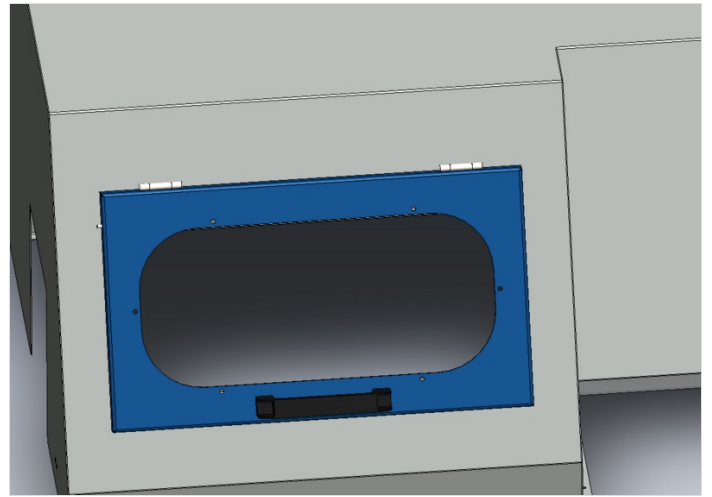

Step 4 - In the following step

It is vital that correct interlock blade alignment is achieved when the door closes onto the interlock switch. Do force should be required for the blade to enter the switch

Perfect alignment must be achieved on these parts when closing and opening the top door



Step 5 - Fit door switch

- 1 Rotate end of interlock switch
- 2 Mount interlock switch to mounting plate as shown using 4 off M4 x 50 socket caps
- 3 Fit interlock blade to top door using 2 off M6 x 16 socket caps

i ...Ecr raised 21/11/23 to add holes to top door for mounting, will require drilling to suit until processed

- 4 Ensure interlock is set to open position
- 5 Mark and drill correct position of interlock assembly onto hood, Fit with M6 x 16 socket caps and M6 A form washers

i ...Ecr Raised 21/11/23 to include add mounting points for interlock assembly to drawing for hood



Step 6 - Fit acoustic sound proofing

Fit acoustic foam to top hood

- 1 Measure 1st section and cut to size using cutting board and straight edge , and fit to hood
- 2 Measure 2nd section and cut to size using cutting board and straight edge , and fit to hood

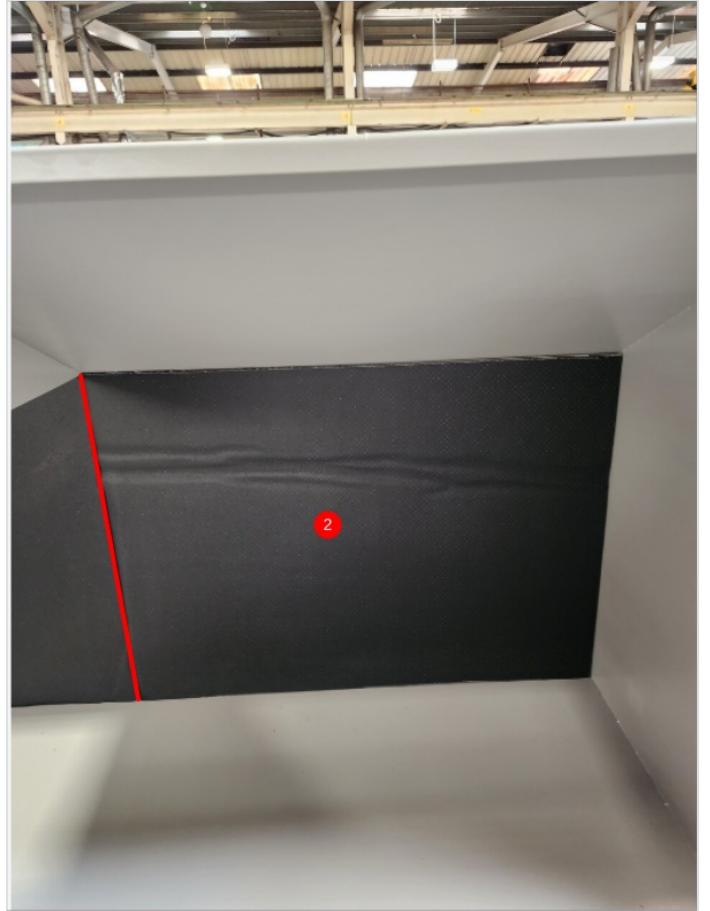
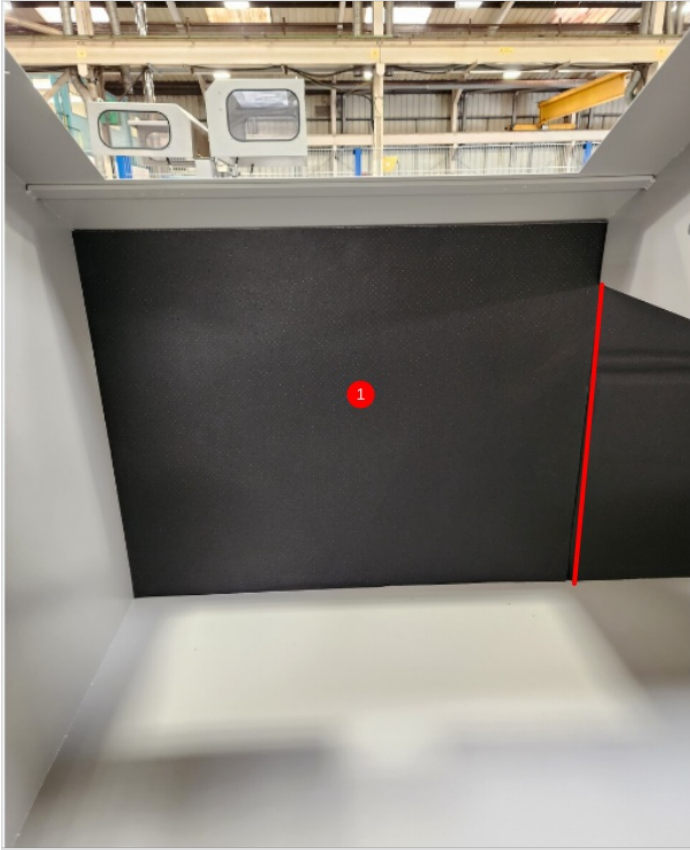



Step 7 - Fit Rear emergency stop

i ...ECR Raised 21/11/23 to add estop mounting holes to drawing. Will require adding on assembly until processed

Fit rear emergency stop module using 4 off M4 x 16 socket caps, 4 off M4 A Form washers and 4 off M4 Nyloc nuts

Please provide drilling details to enable update of part drawing

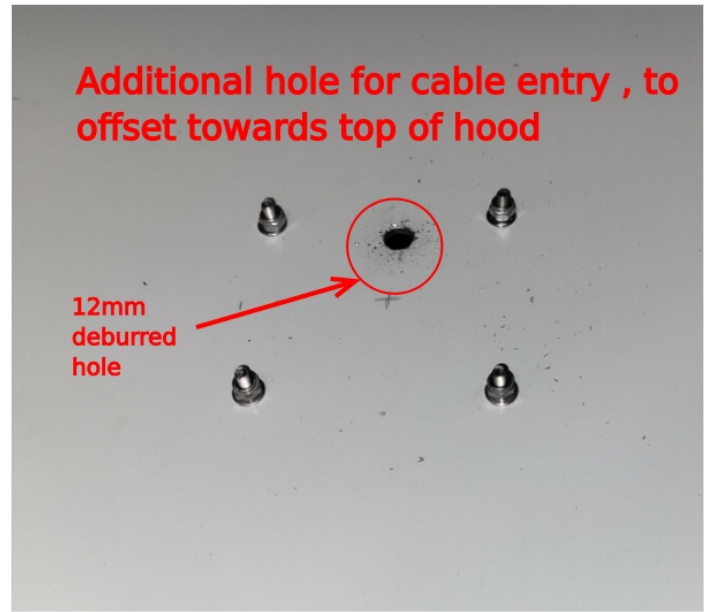
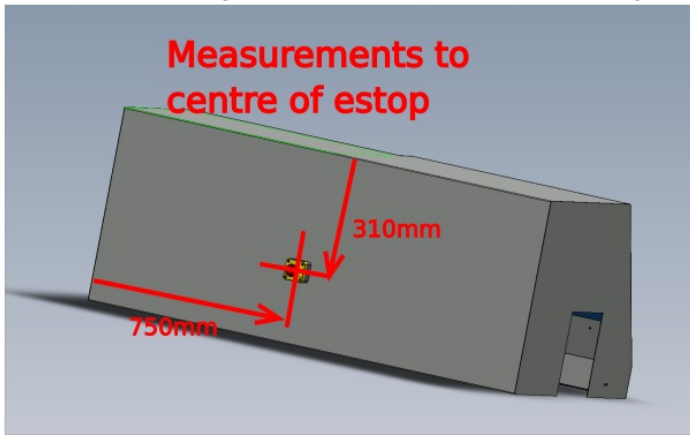

Step 8 - Fit light

i ...ECR raised 21/11/23 to add fixing holes for light to hood drawing . Until processed will require adding on assembly

Use M5 x 10 button sockets and M5 penny washers,
Light will be pre wired by electrical department

Fit light to inside of hood using what fasteners at the position shown

Light should be 75mm down from top face of hood

Ensure clearance is left for mounting of camera

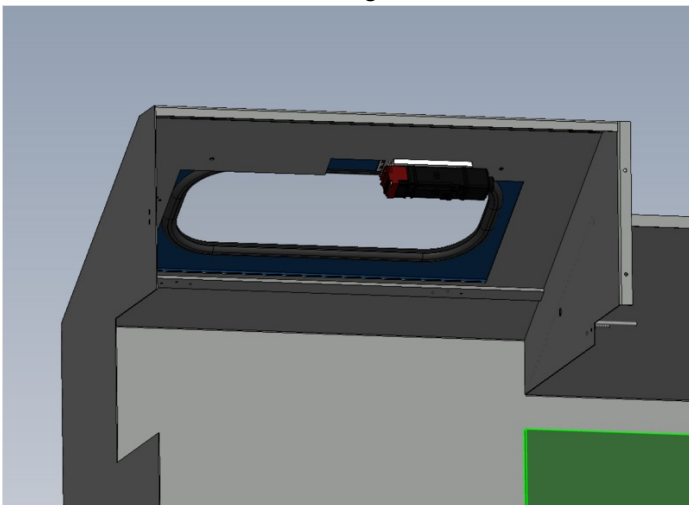





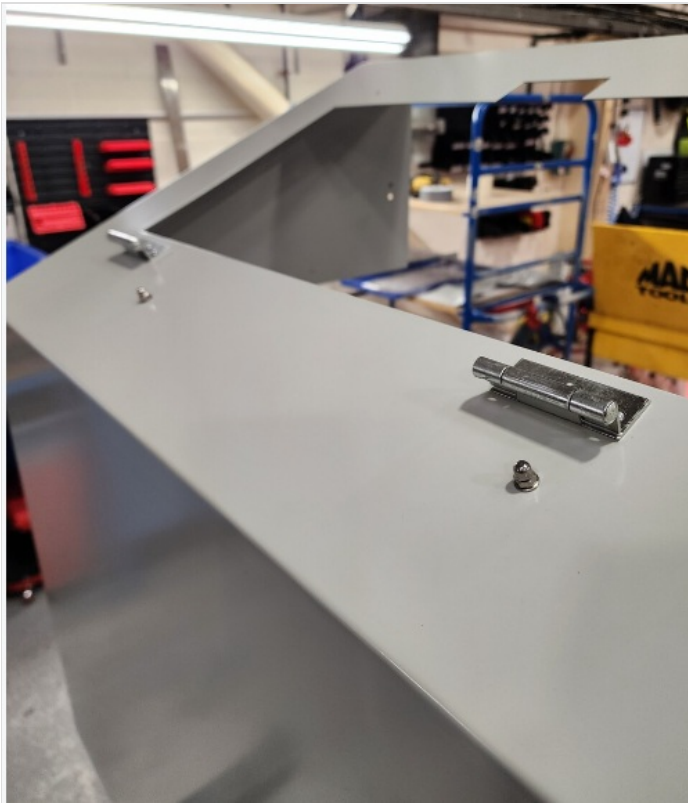

Step 9 - Fit Cable retentions

i ...ECR raised 21/11/23 to add fixing holes for cable bases to hood drawing . Until processed will require adding on assembly

Fit cable tie bases on inside of hood using M4 cable tie bases and fix with M4 button sockets and back off with M4 dome nuts ??

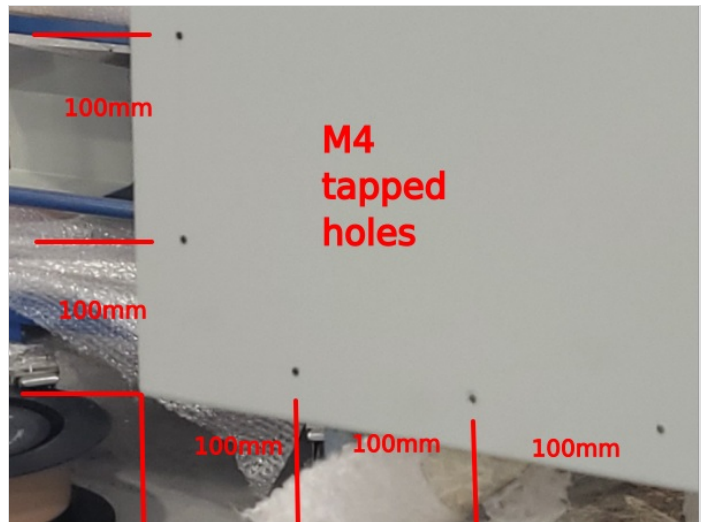
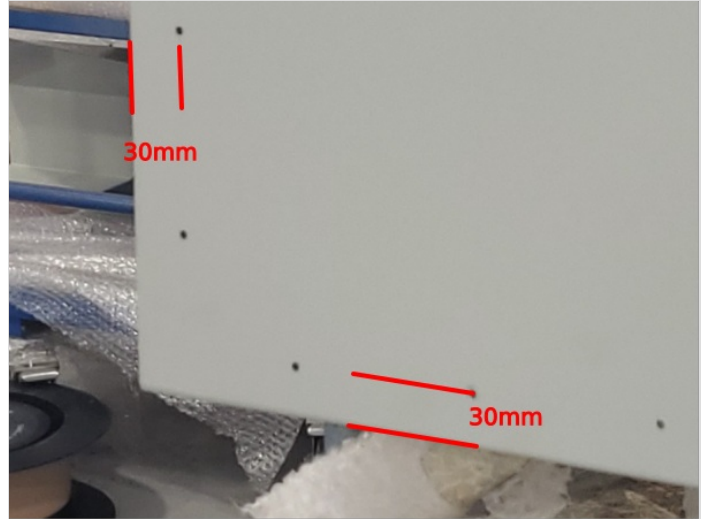
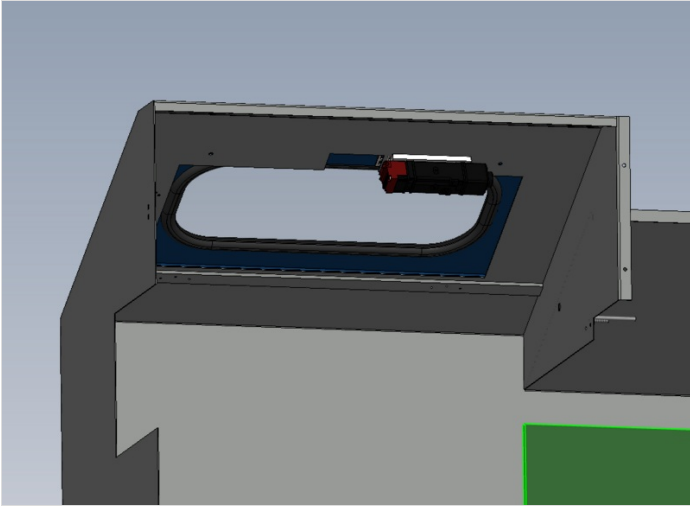

Step 10 - Mount camera

iECR raised 21/11/23 to add fixing holes for camera to hood drawing . Until processed will require adding on assembly. 3 off M4 tapped holes will require adding to hood

Fit C0001239 Micro SD Card 32Gb Class 10 x 1 to camera before mounting

Fit camera to top hood using 3 off M4 x 12 socket caps , and back off with M4 dome nuts and M4 A form washers

Ensure camera is fitted the correct orientation. Camera will have a 'UP' marked on body. This must be at the top

Supply drilling details to capture data to update please

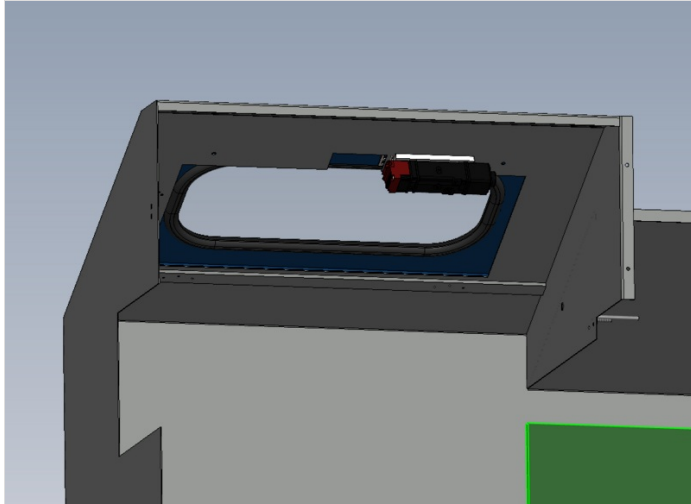

Step 11 - Fit beacon to top hood

Fit beacon to top hood

iECR raised 21/11/23 to add mounting hole for beacon to hood drawing . Until processed will require adding on assembly

Any drilling details add here

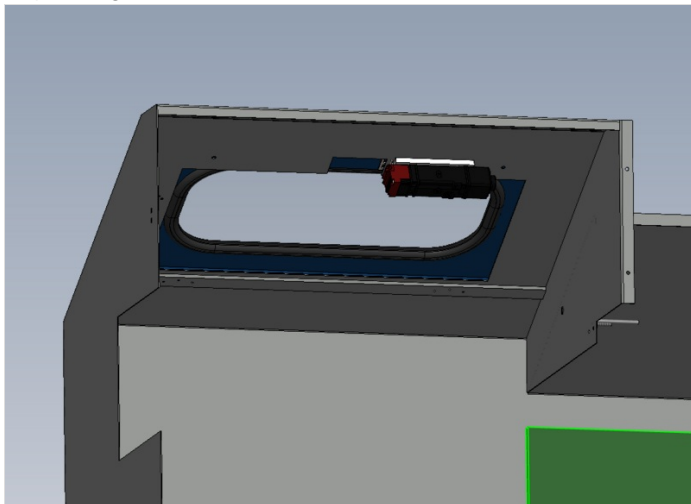

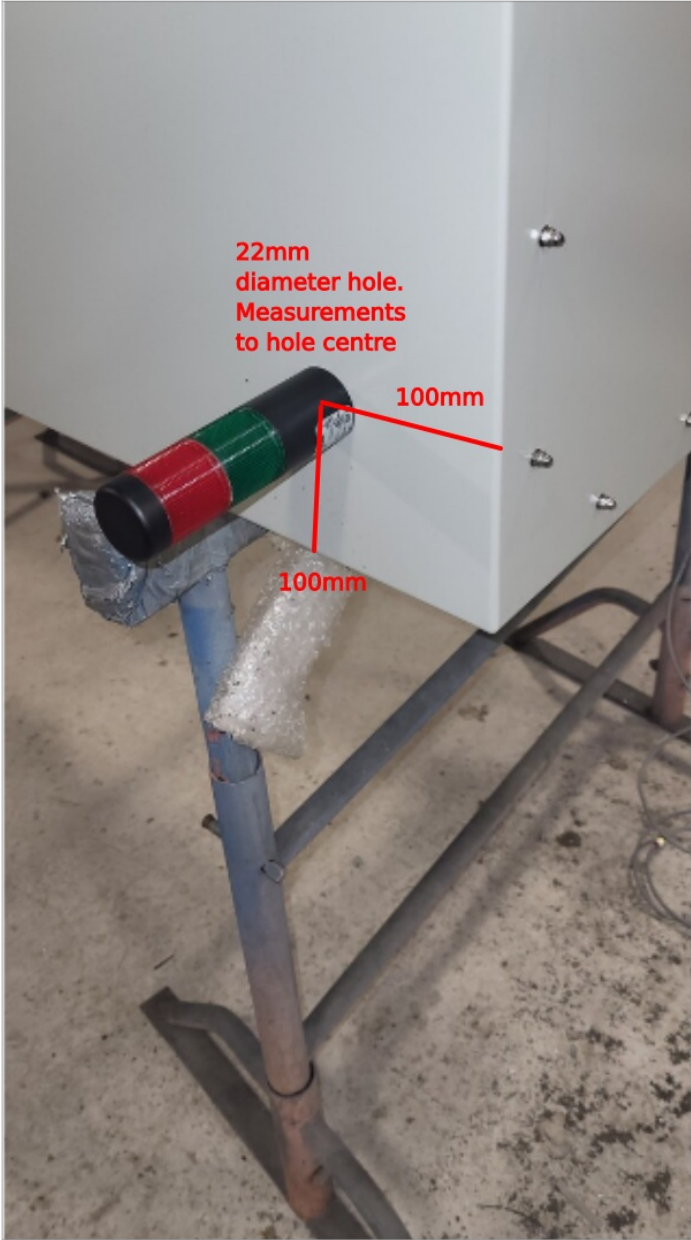

Step 12 - Fit console mount bracket

i ...ECR Raised 21/11/23 to add fixing holes to hood for mounting of console mount. Until processed add on assembly

Fit console mount bracket to top hood (electrical department to provide bracket)

Mount bracket using 2 off M6 x 20 countersunk, 2 off M6 motor plate washer and 2 off M6 Nyloc nuts

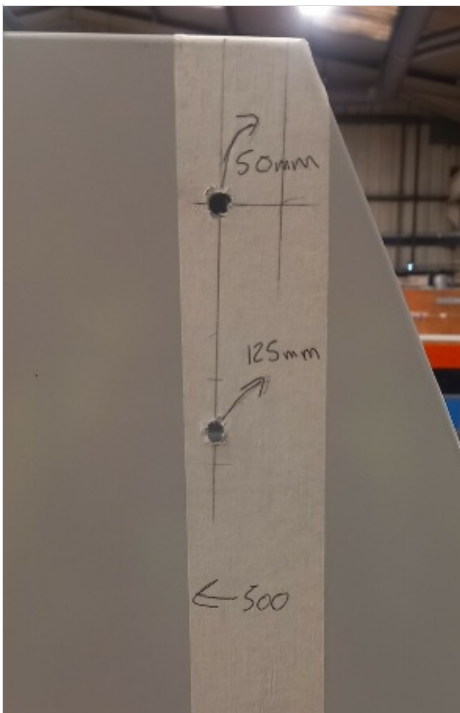
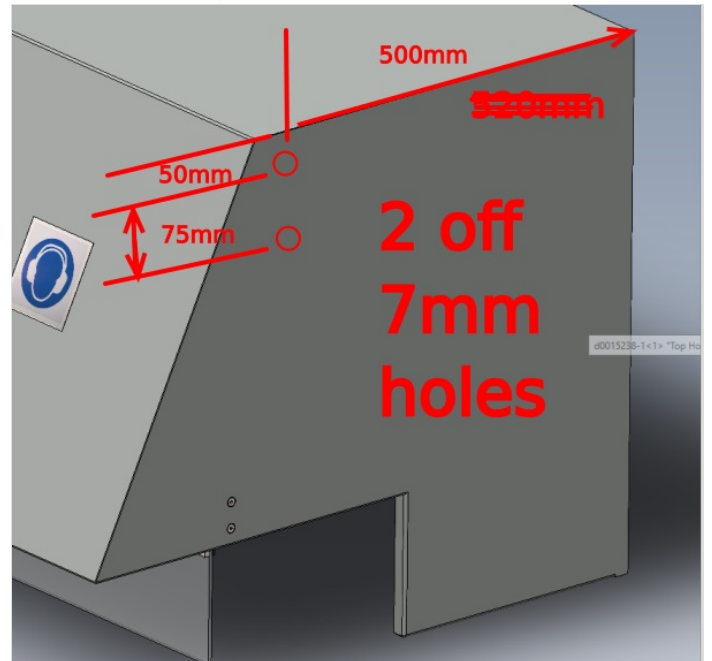
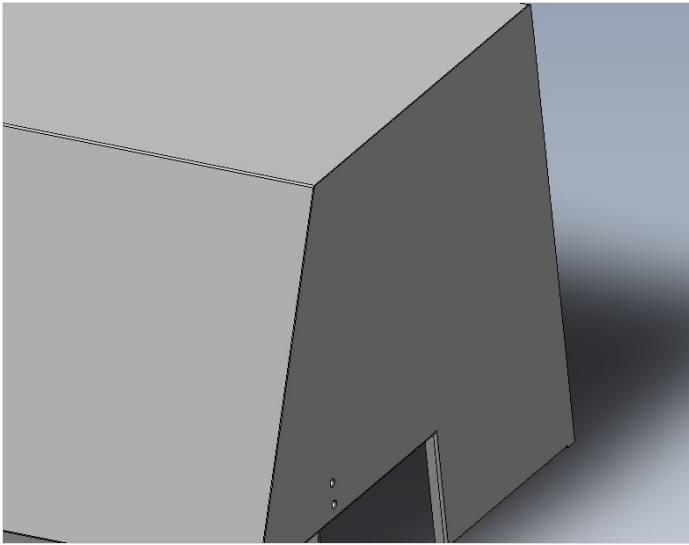

Step 13 - Fit connection box

iECR Raised 21/11/23 to add fixing holes to hood for mounting of console connection box. Until processed add on assembly

Fit abs connection box using 4 off M4 x 16 socket caps

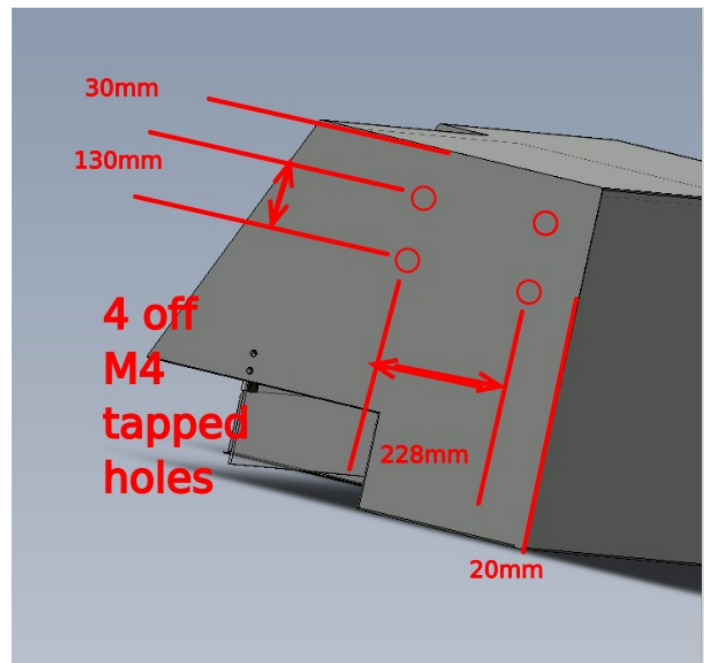

Step 14 - Fit Top door screen

Fit top door screen to top door

Use M6 x 16 socket caps and M6 A form washers on outward facing face

Use M6 penny washers and M6 Nyloc nuts on inside face

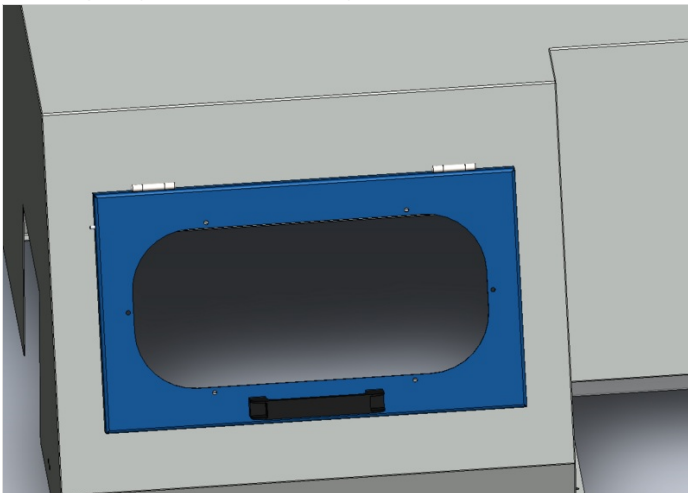

Step 15 - Attach gas strut

Attach gas strut to top door assembly .

1 Use M5 dome nut to secure top ball joint.

2 Use M5 nyloc nut and M5 penny washer to fix bottom ball joint

3 Set correct gas pressure

Gradually adjust gas until correct setting is achieved

Door must lift up under own weight but not open violently

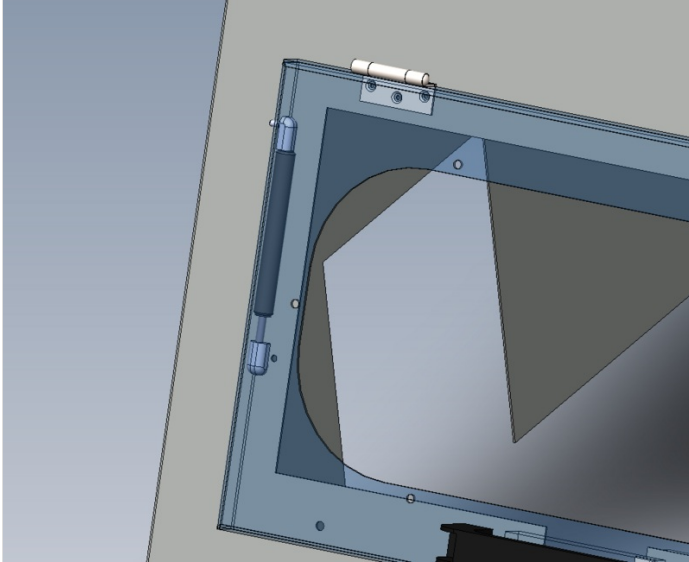

Step 16 - Loom cables

Loom cables to rear lower area of top hood

Network cable to connect camera provided by electrical department

