



R0008013 Clacker assembly

Assembly details for clacker assembly

 Difficulty Easy

 Duration 5 minute(s)

Contents

Introduction

Step 1 - M000101 Compression spring

Step 2 - Components

Step 3 - Fit D0008496 Clacker Pins

Step 4 - Position D0008339 Gap Closer Arm

Step 5 - Drive in pin

Step 6 - Centralise pin

Step 7 - Fit stop

Step 8 - Finish

Comments

Introduction

Tools Required

10mm spanner
5mm punch
Ball pein hammer

Parts Required

D0008339 Gap Closer Arm x 1
D0008340 Gap Closer Base x 1
D0008496 Clacker Pins x 1
M0000101 Compression Spring 11 D 15 D 25 Long x1
F0000185 M6 x 16 Hex set S/S x 1

Step 1 - M000101 Compression spring

M0000101 is not required for bench assembly , and will not be shown within the work instruction .



Ensure this part is issued with each assembled clacker

Step 2 - Components

D0008339 Gap Closer Arm x 1
D0008340 Gap Closer Base x 1
D0008496 Clacker Pins x 1
F0000185 M6 x 16 Hex set S/S x 1



Step 3 - Fit D0008496 Clacker Pins

Use ball peen hammer to locate D0008496 Clacker Pins into
D0008340 Gap Closer Base as shown

Ensure pin does not go past indicated face



Step 4 - Position D0008339 Gap Closer Arm

Position D0008339 Gap Closer Arm as shown

 ...It is vital to orientate this part correctly. Note the offset between the arm and base when orientated correctly



Step 5 - Drive in pin

Drive pin through parts until flush with face

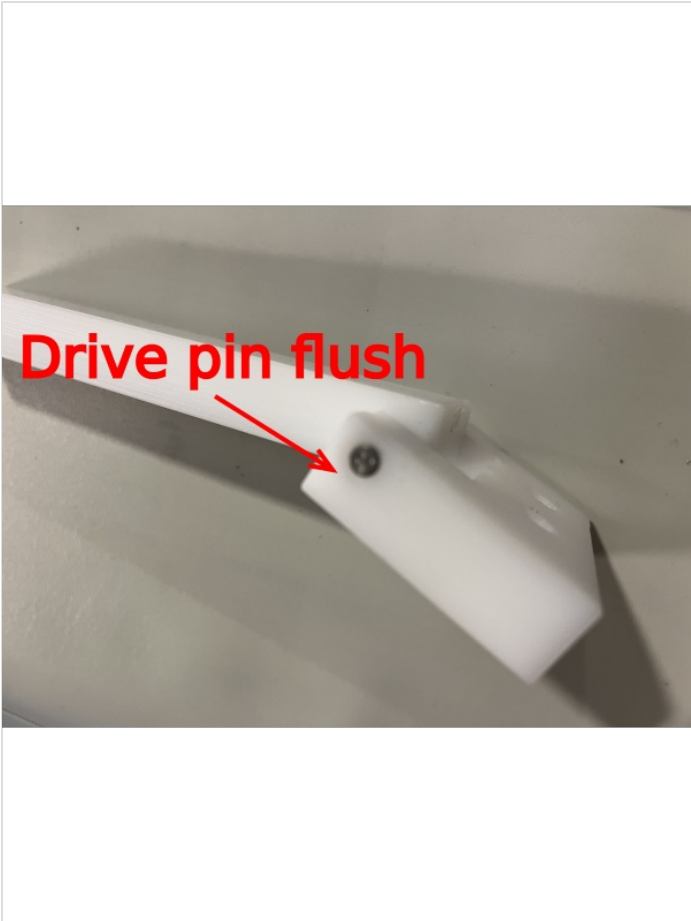

Step 6 - Centralise pin

Use a 5mm punch and ball peen hammer to centralise pin between the 2 outer faces of D0008340 Gap Closer Base

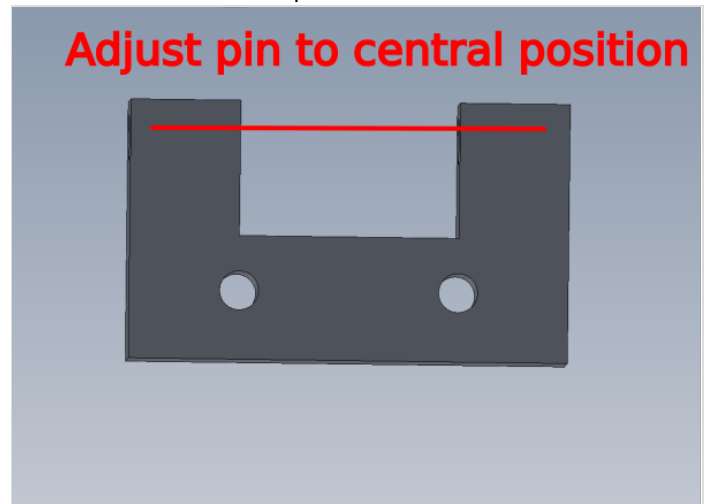
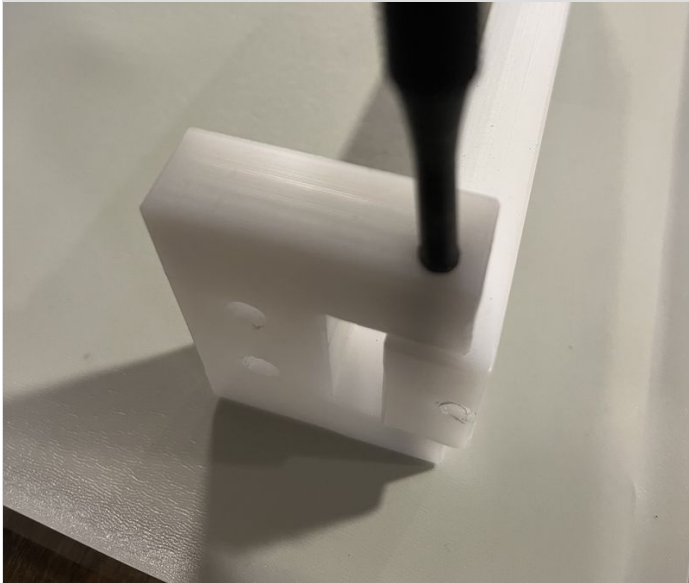

Step 7 - Fit stop

⚠ ...F0000185 M6 x 16 Hex set S/S bolt is used as a stop. It is vital that this part is not set any further into the assembly than described in the steps below

Position assembly as shown

Fit M6 set bolt by hand

Slowly adjust set bolt by winding into the assembly until the shown position is achieved by the base and arm when Head of set bolt contacts the clacker base

DO NOT SET ANY FURTHER THAN THIS POSITION

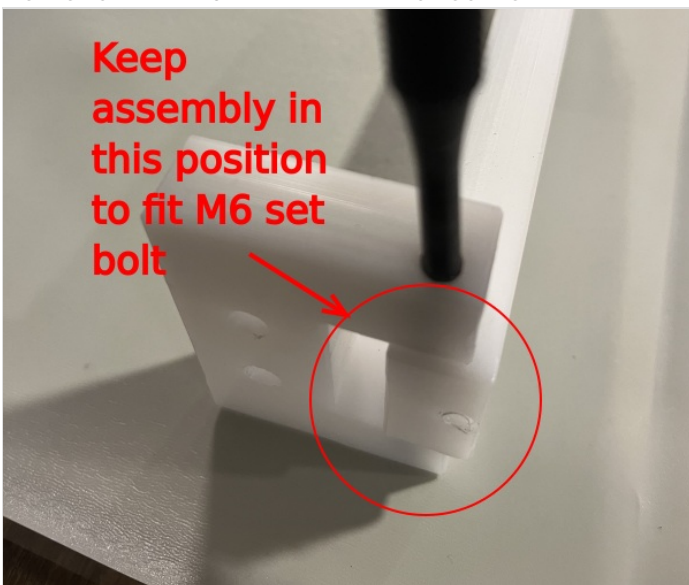

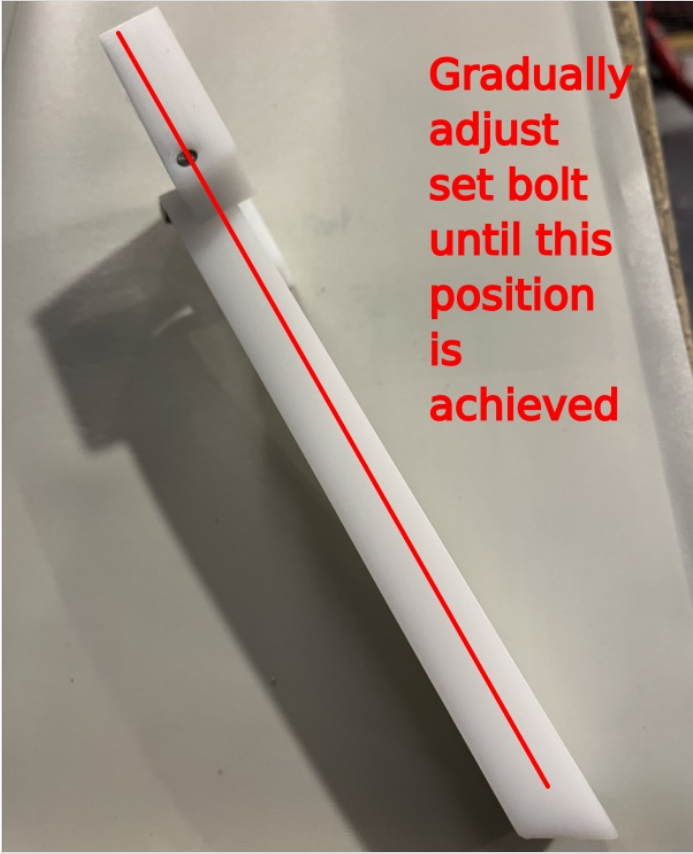

Step 8 - Finish

Check list

Pin centralised

Set bolt adjusted

Clacker arm and base pivots on pin by hand

