

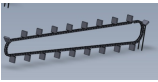

# ZX5 Build Manual - A Infeed

Build Manual for ZX5 Infeed



R0000699 Bench assemble drive chains  
Instructions to assemble drive chains for arms



R0015030B Bench assemble loader wheel  
Instructions to assemble loader wheel



R0015086 Pneumatic connections  
Instructions for adding pneumatic circuits to main frame

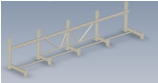

R0015243 ZX5 module A-C-E Frame levelling  
Method for levelling bare frames for modules A,C and F for ZX5/3 Preparing frame for production

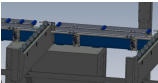

R0015259 Mount roller beds to mainframe  
Fitting details for completed assemblies

R0015260 Electrical cable loom Fitting  
Instructions for adding wiring ;looms to main frame

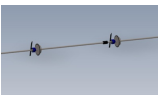

R0015262 Drive shaft fitting  
Instructions for fitment of loader chain drive shafts

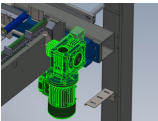

R0015263 Mount drive motor for load shaft  
Instructions to mount loading arms drive shaft motor

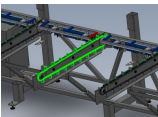

R0015264 Fit Loader chains to arms  
Instructions to fit loader chains to arms

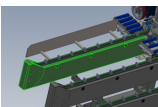

R0015265 Mount Infeed arm covers and End guards  
Instructions to fit safety covers to arms

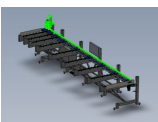

R0015266B mount completed assemblies  
Instructions to mount pre built assemblies to frame

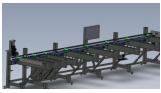

R0015267 Assemble Backfences, Fit and Align  
Alignment requirements and details for Backfence



R0015268 Pneumatic module Test  
Instructions for performing pneumatic test on completed module



R0015269 Fit Frame ancillaries  
Instructions to fit ancillaries such as wire basket

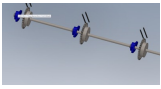

R0015270 Bench assemble Shafts, bearings and sprockets  
Instructions to check parts and prepare for fitting

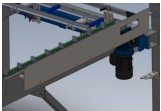

R0015271 Mount buffer bars  
Instructions to mount buffer bars

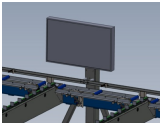

R0015351 Mount monitor to Frame  
Instructions to mount monitor to main frame



R0015079 Infeed extension assembly  
Assembly instructions for infeed module A extension section



R0015078B Module A infeed arm alignment  
Process for alignment of infeed arms



R0015356 Assemble Pneumatics on to electrical cabinet  
Instructions to mount pneumatic components

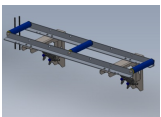

R0015090 Bench Assemble Roller Tables  
Instructions for bench assembling Roller tables

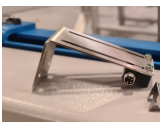

R0015080 Bench Assemble Sensor Rail  
Instructions for bench assembly of sensor rail components



R0015081 Bench Assemble Single Roller Table  
Assembly details for individual roller assembly

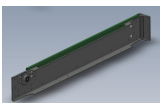

R0015121 Bench assemble Infeed arms  
Instructions for bench assembling infeed arms