

# Fichier:Zebra ZD421 - Print head change Image.png

## ZD621 and ZD421 Direct Thermal

### Removing the Printhead

1. Turn the printer OFF. Open the printer.

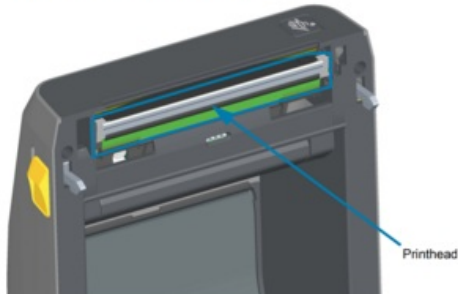

2. Push the printhead release latch away from the printhead. The right side of printhead releases.

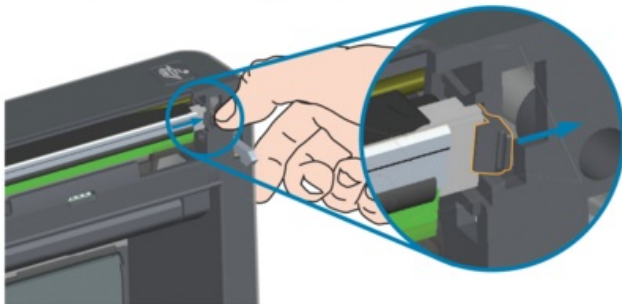

3. Swing the loose right side of the printhead out of the printer. Pull it out and to the right a little to get the left side of the printhead clear. Pull the printhead out and free of the top cover to gain access to its attached cables on the backside of the printhead. Note, the red highlights the left side printhead retainer slot.

Size of this preview: 529 × 600 pixels.

Original file (1,238 × 1,404 pixels, file size: 584 KB, MIME type: image/png)

## File history

Click on a date/time to view the file as it appeared at that time.

	Date/Time	Thumbnail	Dimensions	User	Comment
current	16:07, 14 September 2023		1,238 × 1,404 (584 KB)	Gareth Green (talk   contribs)	

You cannot overwrite this file.

## File usage

The following page links to this file:

Zebra ZD421 - Print head change